

BALLROOM LEVEL MEETING SPACE

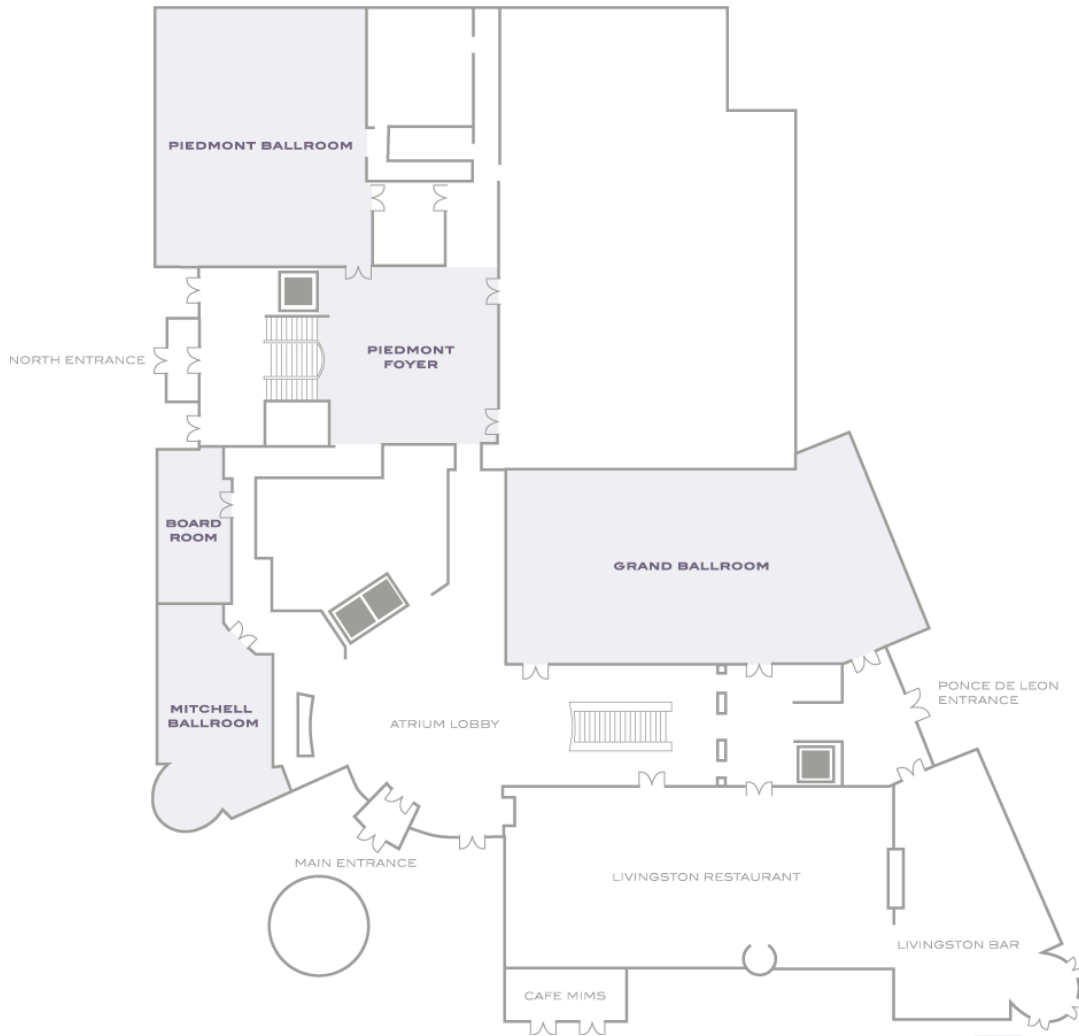

	WIDTH	LENGTH	SQFT	CEILINGHT	THEATER	CLASS 4 PER	BANQUET	RECEPTION NO SEATING	CONF 4 PER	U SHAPE 4 PER	HS 4 PER	HALF RND CRESCENT
Grand Ballroom	42	98	4,116	19	250	125	220	300	50	36	48	80
Piedmont Ballroom	59	48	2,832	18	200	100	150	200	24	28	32	
Piedmont Foyer	40	37	1,480	18	n/a	n/a	n/a	175	n/a	n/a	n/a	n/a
Georgian Boardroom	42	16	672	18	n/a	n/a	n/a	n/a	12	n/a	n/a	n/a
Mitchell Ballroom	24	40	960	18	120	50	60	100				

Talk to our Sales Department 404.897.1991

GEORGIAN TERRACE HOTEL

659 PEACHTREE STREET NE, ATLANTA, GA 30308 | WWW.THEGEORGIANTERRACE.COM
 TOLL FREE (800) 651-2316 | DIRECT (404) 897-1991 | FACSIMILE (404) 724-0642

LOWER LEVEL ATLANTA CONFERENCE CENTER

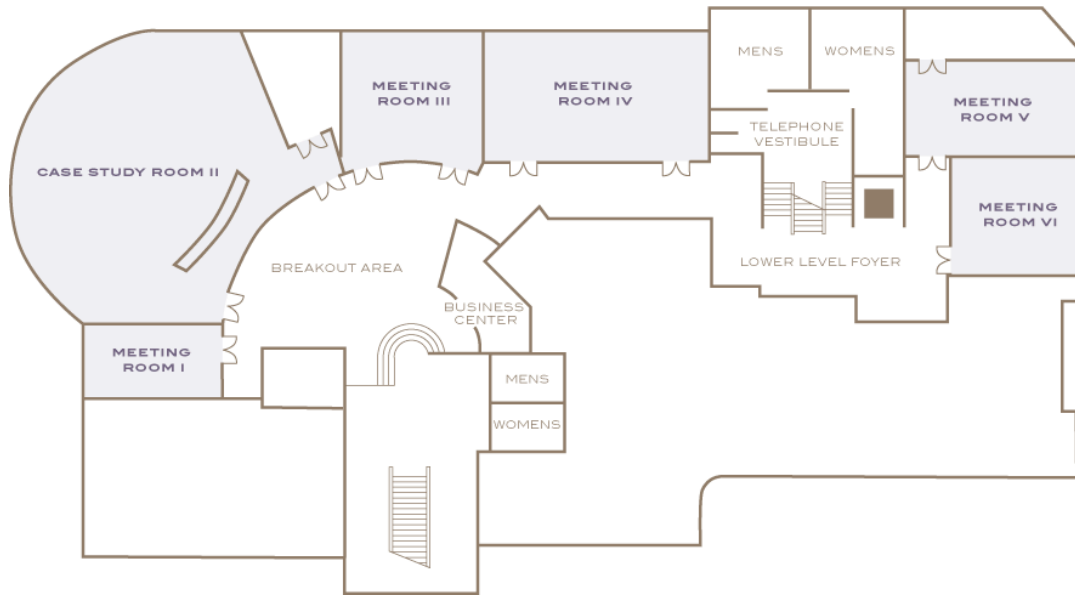

	WIDTH	LENGTH	SQFT	CEILING HT	THEATER	CLASS 4 PER (CONF CHAIR)	BANQUET	RECEPTION NO SEATING	CONF 4 PER (CONF CHAIR)	U SHAPE 4 PER (CONF CHAIR)	HS 4 PER (CONF CHAIR)	HALF ROUND CRESCENT (CONF CHAIR)
Conference I	15	26	390	9	n/a	n/a	n/a	n/a	10	n/a	n/a	n/a
Case Study II	58	38	2,204	8	120	80	120	160	30	20	40	60
Conference III	30	22	660	10	75	20	60	120	22	26	28	36
Conference IV	22	45	990	10	75	40	60	120	30	30	36	36
Conference V	19	34	646	10	50	25	50	100	20	24	24	30
Conference VI	24	26	624	10	35	20	40	80	18	16	20	24
Center Foyer	24	42	1,008					200				

Talk to our Sales Department 404.897.1991

GEORGIAN TERRACE HOTEL

659 PEACHTREE STREET NE, ATLANTA, GA 30308 | WWW.THEGEORGIANTERRACE.COM
 TOLL FREE (800) 651-2316 | DIRECT (404) 897-1991 | FACSIMILE (404) 724-0642



Step back in time to the opulent splendor of the Egyptian Pharaohs, or into the mystique of a Middle Eastern palace. The Egyptian Ballroom and Grand Salon are lavishly decorated with sweeping columns and ornamentation creating the perfect setting for weddings and receptions, corporate events and association functions. From a luncheon or dinner for 100 guests, to a pre-show cocktail party or post-show dessert extravaganza for 1200, we have set the stage with elegance and fantasy.

The Theatre, Egyptian Ballroom and Grand Salon have been completely renovated to their original grandeur. The Fox provides complete beverage service, a state-of-the-art kitchen, and we can suggest musicians, caterers and other supporting cast.

The area adjoining the Grand Salon and Egyptian Ballroom includes coat check facilities, ladies' and gentlemen's lounges, and plenty of space to mingle. The Fox Theatre and ballrooms are A.D.A. compliant.

For corporate events, conventions and association events, weddings or other social events, contact Sales and Marketing at (404) 881-2100.

wine
& dine
among
kings &
queens

The Fox Theatre, 660 Peachtree Street, Atlanta, Georgia 30365
WWW.FOXTHEATRE.ORG



Ballroom	Meeting Facilities*			
	Egyptian Ballroom with an elevated 11' x 25' stage and balcony	Grand Salon	Grand Terrace	Combined Rooms
Square Feet	6,840	3,350	1,272	11,462
Room Size	90' x 76'	67' x 50'	53' x 24'	---
Banquet Seating	520	200		
Reception or Theatre Seating	800	300		
Classroom Seating	400	200		
Ceiling Height	25' Perimeter 30' Clerestory	12'	---	---

*MAXIMUM CAPACITY

